

MixRite 3.5



0.03% - 0.2%

SEAL KIT REPLACEMENT GUIDE

Tefen Flow and Dosing Technologies Ltd.
Kibbutz Nahsholim 3081500, Israel

Tel +972 4 6395550

Fax +972 4 6390813

Website: <https://www.tefentech.com>

Email: info@tefentech.com

MIXRITE 3.5 SEALS REPLACEMENT

Changing the seals on MixRite 3.5 0.03-0.2% is done annually (based on usage) or when following malfunctions occur:

- The pump "stutters" or does not operate at all during low flow.
- Irregular suction or lack of suction.

DISASSEMBLING MIXRITE 3.5

1. Turn off the water supply and verify there is no pressure in the pipe.
2. Remove the top cover by rotating it counter-clockwise.
3. Release the hose nut and remove the suction tube.

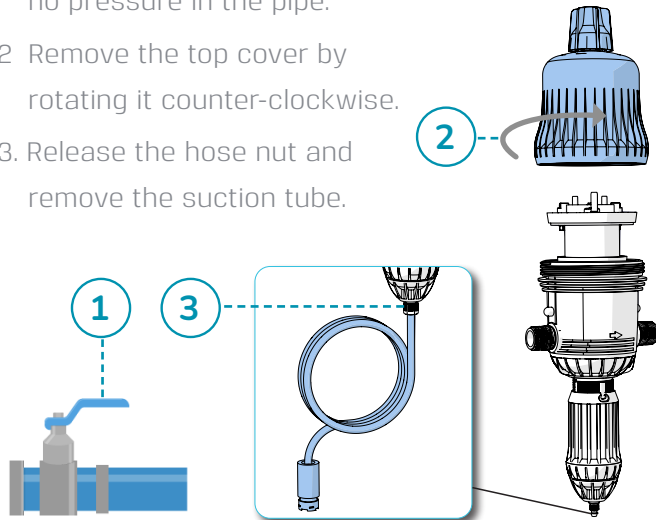

4. Pull out the engine unit.

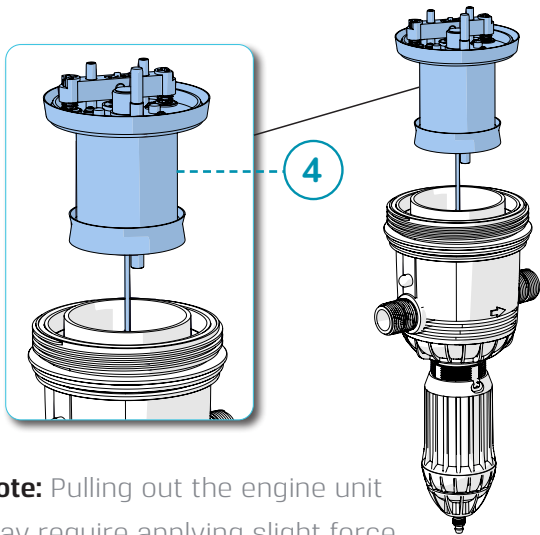

Note: Pulling out the engine unit may require applying slight force.

5. Verify the engine rod is pressed up.

6. Grasp the piston adjuster using pliers, and remove the piston by rotating it a quarter turn clockwise and pulling it out.

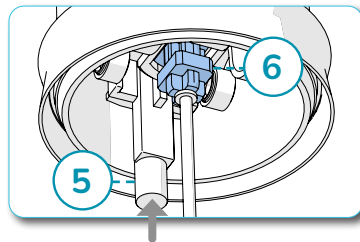

Caution: Do not grasp the piston itself with the pliers.

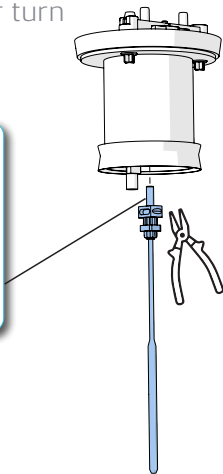

SUCTION SEAL

1. Remove the bottom nut.
2. Gently pull out the check valve.
3. Remove the cylinder latch nut.

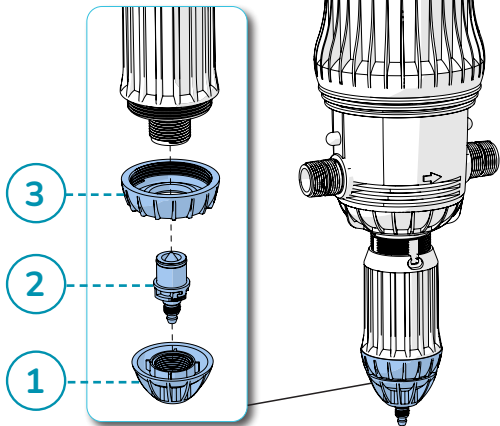

4. Close the adjustment sleeve nut to expose the cylinder.
5. Remove the cylinder by wiggling it while pulling down.

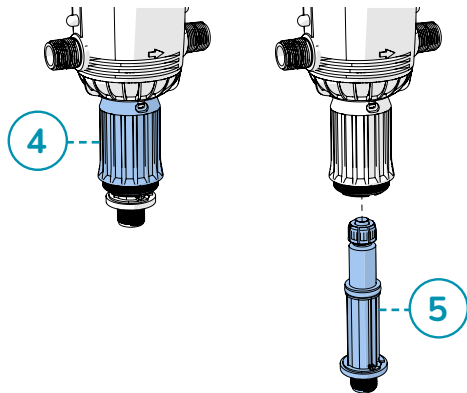

6. Remove the cylinder seal adjuster nut.

7. Remove the cylinder seal adjuster.

8. Remove the suction seal.

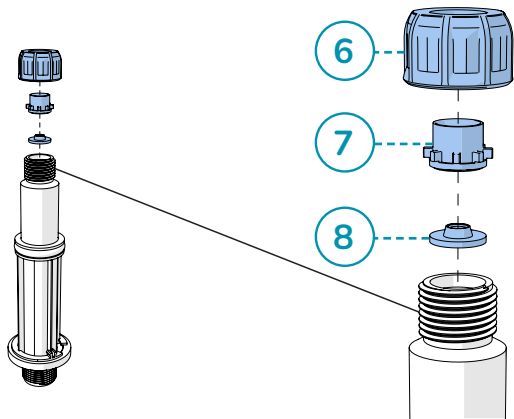

9. Clean the seal base.

10. Insert a new seal.

11. Reassemble the seal adjuster and seal adjuster nut in reverse order.

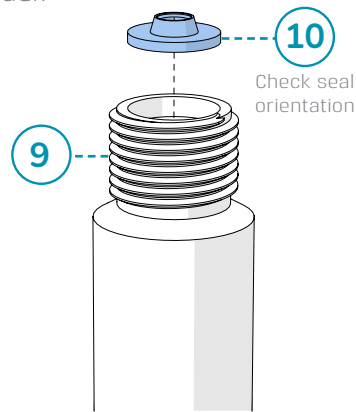

12. Apply silicone grease and insert the cylinder back by pushing it halfway into the housing.
13. Align and insert the clips on the ring with the gaps in the cylinder housing.
14. Push the cylinder into place by applying a slight force.

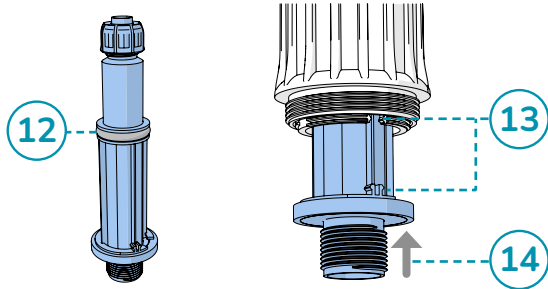

15. Open the adjustment sleeve nut until aligned with the bottom of the cylinder.
16. Place the cylinder latch nut, suction check valve, and bottom nut back onto MixRite.

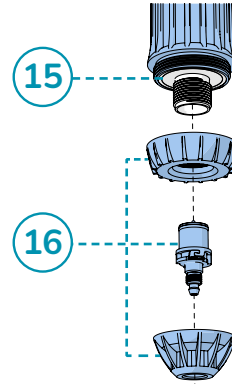

ENGINE TOP SEAL

1. Gently pull off the seal from top of the engine using long-nose pliers.
2. Place a new seal on top of the engine.

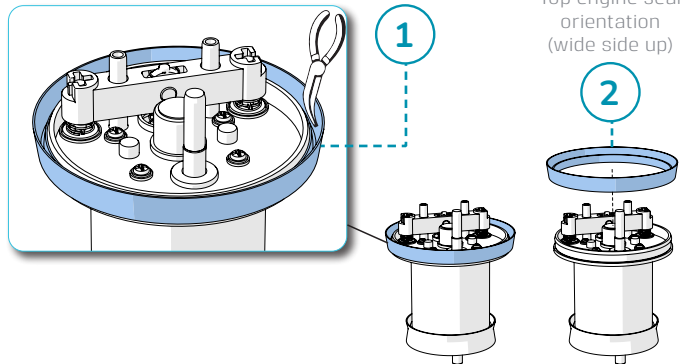

3. Apply silicone grease to the new seal.

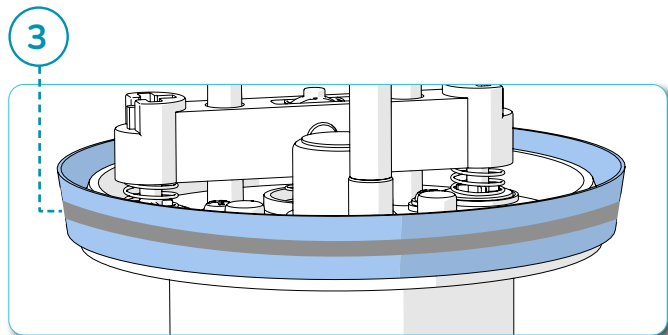

Note: Do not use a tool to place the seal. If needed, put the seal in hot water to make placement easier.

ENGINE BOTTOM SEAL

1. Pull off the seal from the bottom of the engine using long-nose pliers.

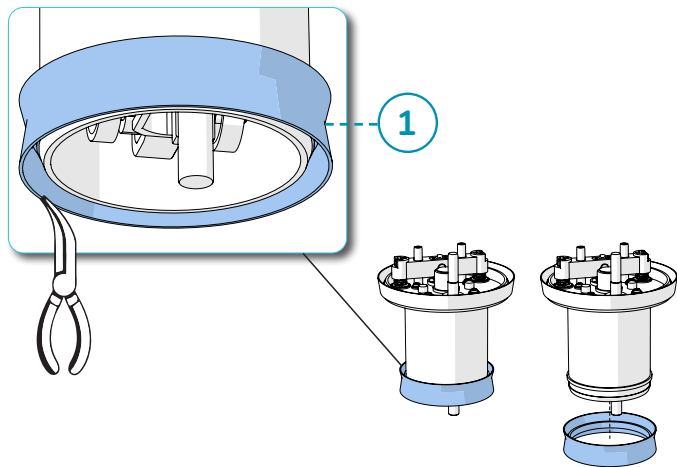

2. Place a new seal on bottom of the engine.
3. Apply silicone grease to the new seal.

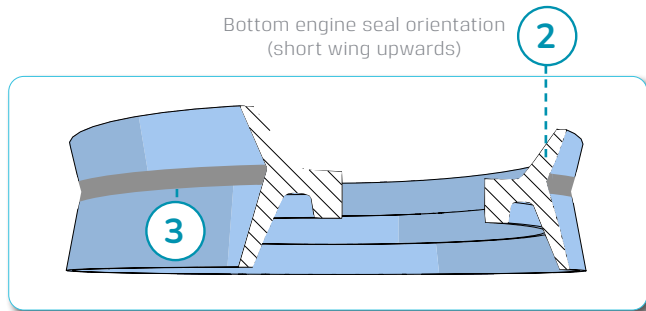

Note: Do not use a tool to place the seal. If needed, put the seal in hot water to make placement easier.

REASSEMBLING MIXRITE 3.5

1. Verify the piston is clean.
2. Attach the piston to the engine unit by inserting and rotating it a quarter turn clockwise to lock in place.

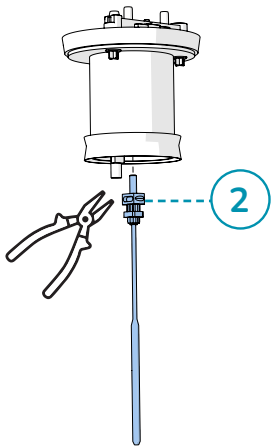

3. Insert the piston through the center of the spider.
4. Verify the O-ring is correctly positioned and close the top cover.

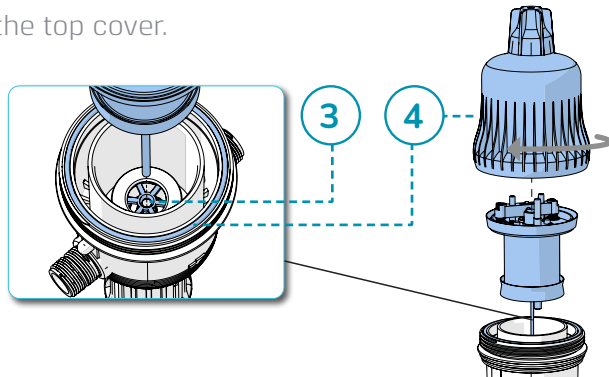

Note: The engine unit should partially be inserted into the pump and secured in place using the top cover.

Scan the QR Codes:

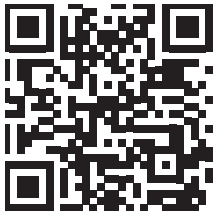

Full MixRite 3.5 0.03 - 0.2%
Installation and Operation Guide

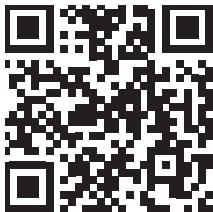

MixRite 3.5 0.03-0.2%
Seal Kit Replacement Video