

Tefen Flow Products

Anti Vacuum/Drain Valves

Applications:



Agriculture



Industry

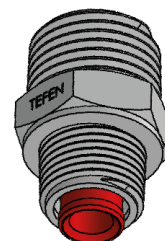

Technical Info



Working pressure

Up to 10 BAR (145.04 psi)
at 20 °C



Temperature

Up to 90°C
(subject to application)

Material

Acetal

Product code	Thread BSPT	Color
22273008002	1/2"	Black
22273108002	1/2"	

Anti Vacuum Valve (cat. no. 22273008002)

Designed to prevent undesired suction of additive when the water flow is shut off and the drip line is draining. It is installed vertically upwards on the highest point.

Drain Valve (cat. no. 22273108002)

Designed to ensure automatic drainage of condensed water in compressed-air lines, after compressed air supply is shut-off. It is equipped with stainless spring and installed at the pipe end.

Main advantages:

- Anti corrosive
- High quality & high resistant materials
- UV resistance
- Simple, compact & reliable
- Reduces malfunctions

