

# MixRite 2.5

For PVDF, IBP and BP Models



## SEAL KIT

## REPLACEMENT GUIDE

Tefen Flow and Dosing Technologies Ltd.

Kibbutz Nahsholim 3081500, Israel

Tel +972 4 6395550

Fax +972 4 6390813

Website: [www.tefentech.com](http://www.tefentech.com)

Email: [info@tefentech.com](mailto:info@tefentech.com)

# SEALS REPLACEMENT



Changing the seals on MixRite 2.5 is done annually (based on usage) or when following malfunctions occur:

- The pump “stutters” or does not operate at all during low flow.
- Irregular suction or lack of suction.

# PREPARATION

1. Turn off the water supply and verify there is no pressure in the pipe.
2. Remove the suction tube.

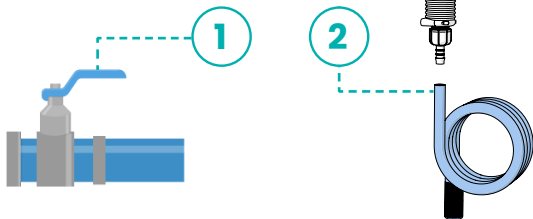

# DISASSEMBLY

1. Remove the top cover by rotating it counter-clockwise.
2. Ensure the O-ring remains in place.

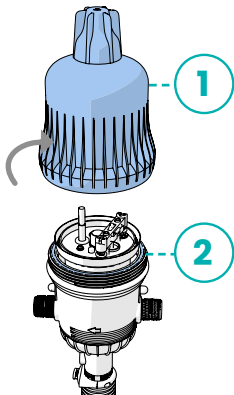

**Note:** Rotation directions are presented from the top view perspective of the rotated item.

3. Release the cylinder support nut by rotating it clockwise.
4. Remove the cylinder support unit.

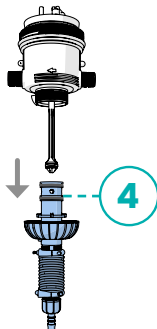
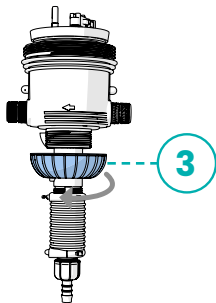

**Note:** Pulling out the cylinder support unit may require applying slight force.

5. Release the piston by rotating it a quarter turn clockwise.
6. Pull out the engine unit.

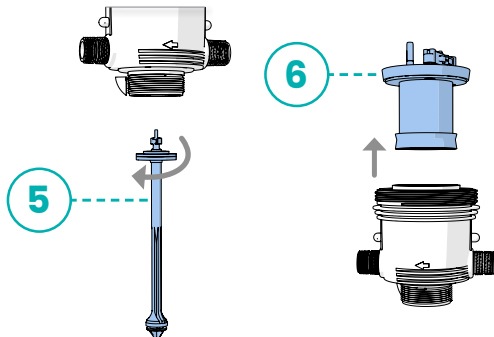

# ENGINE TOP SEAL

1. Gently pull out the seal from the top of the engine using long-nose pliers.

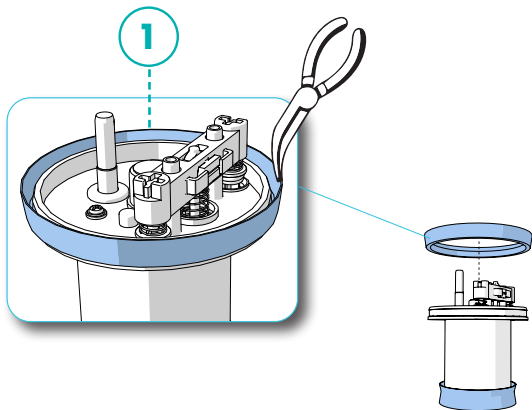

2. Place a new seal on the top of the engine.

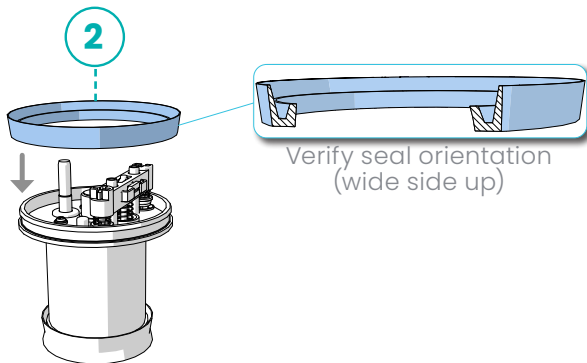

**Note:** Do not use tools to place the seal. If needed, put the seal in hot water to make placement easier.



# ENGINE BOTTOM SEAL

1. Gently pull out the seal from the bottom of the engine using long-nose pliers.

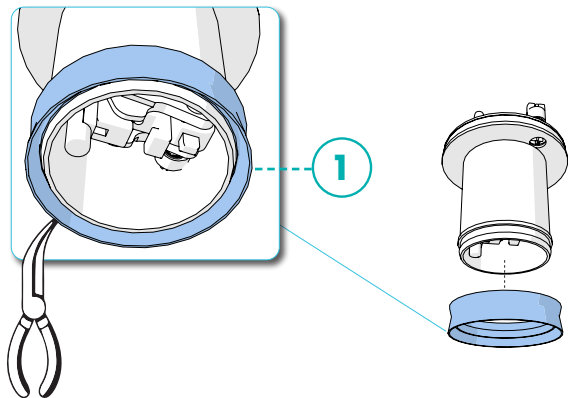

# ENGINE BOTTOM SEAL PLACING

1. Place a new seal on the bottom of the engine.

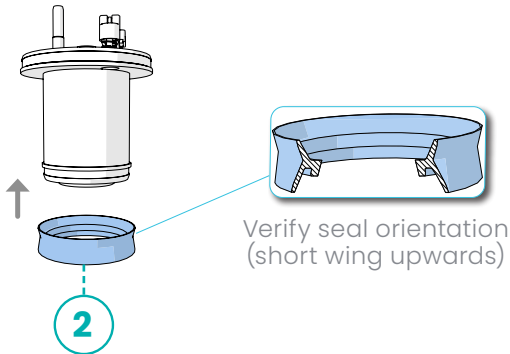

**Note:** Do not use tools to place the seal. If needed, put the seal in hot water to make placement easier.

# SUCTION SEAL REPLACEMENT

1. Remove the suction seal using screwdriver.
2. Place a new seal on the bottom of the suction piston.

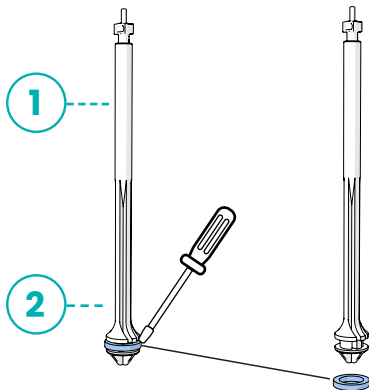

3. Apply silicone grease on top and bottom engine seals.

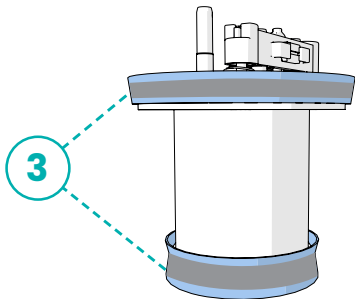

4. Insert the engine unit into the base.
5. Insert the upper disk into the base before inserting the piston.

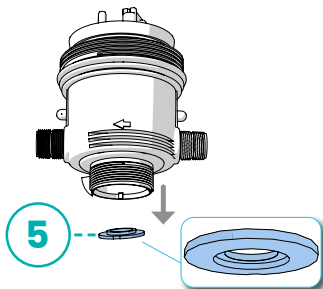
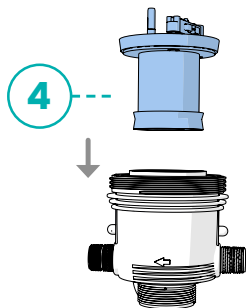

Verify disc  
orientation  
(lip upwards)

6. Insert the piston into the base and secure with a quarter turn counter-clockwise.
7. Apply silicone grease to the O-rings.

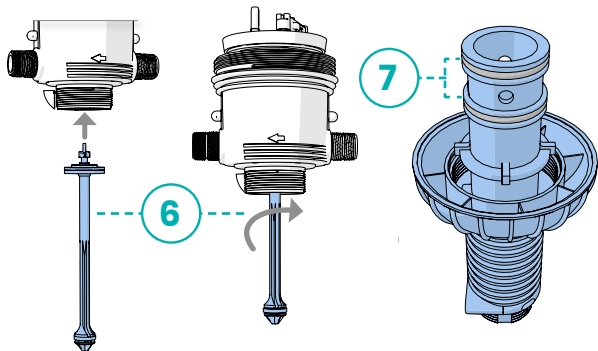

8. Insert the cylinder support unit into the base. Ensure the tenon is placed into the corresponding slots.

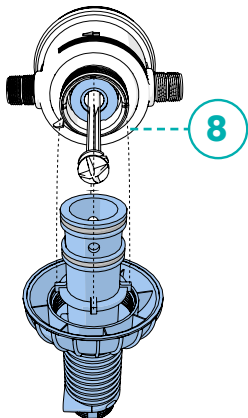

9. Close the cylinder support nut by rotating it counter-clockwise.

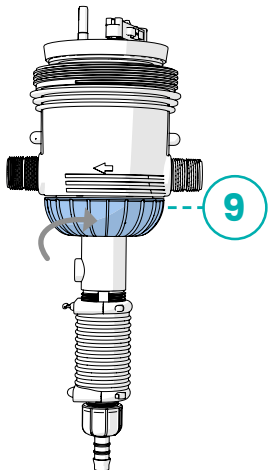



## 10. Ensure the O-ring is in place.

Close the top cover by rotating it clockwise.

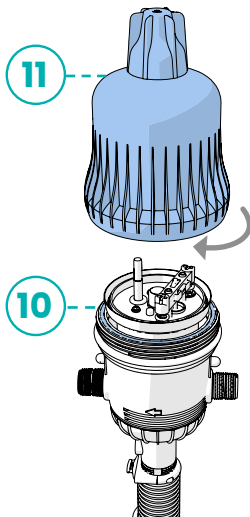

## Scan the QR Codes:



Download the TEFEN  
Application



Full MixRite 2.5 Installation and  
Operation Guide

